

ANEXO II

ESTOJOS PLÁSTICOS PARA ACONDICIONAMENTO DE MÍDIAS

- 1) MA20 e MR20 - Fotos com sugestão de layout dos estojos para armazenamento de, pelo menos, 20 mídias, nos modelos MA20 e MR20 (as medidas máximas constam na imagem):

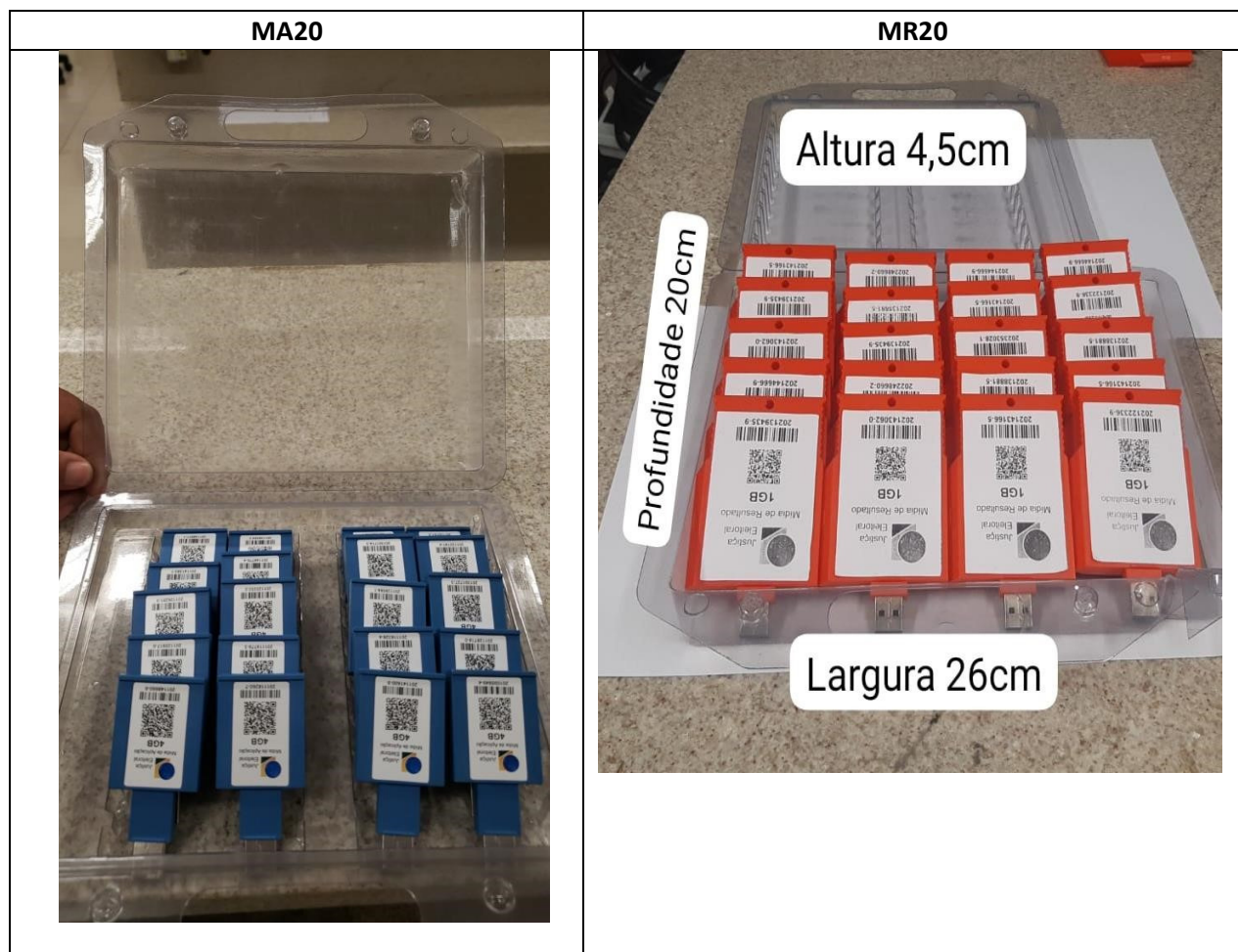

- 2) MR50 - Foto com sugestão de layout do estojo para armazenamento de, pelo menos, 50 mídias de resultado, no modelo MR50:

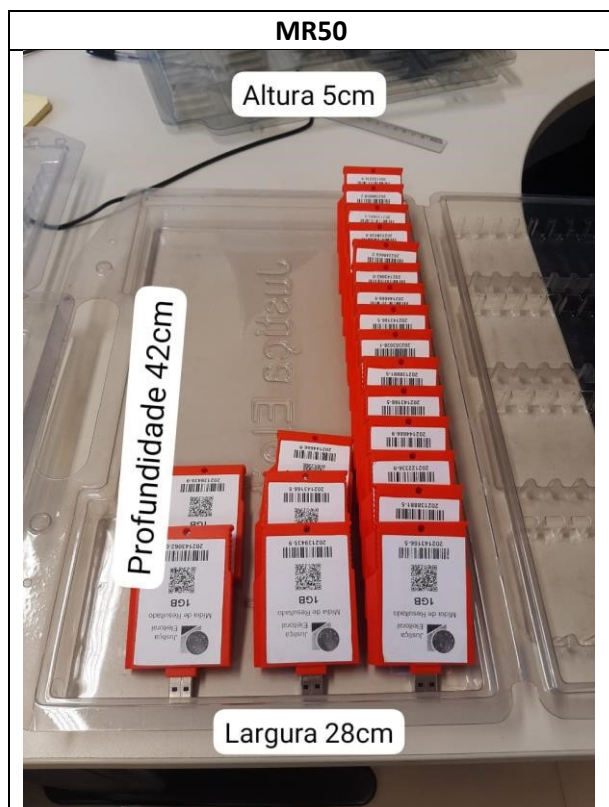

- 3) MA50 - Foto com um tipo de sugestão de layout do estojo para armazenamento de, pelo menos, 50 mídias de resultado, no modelo MA50:

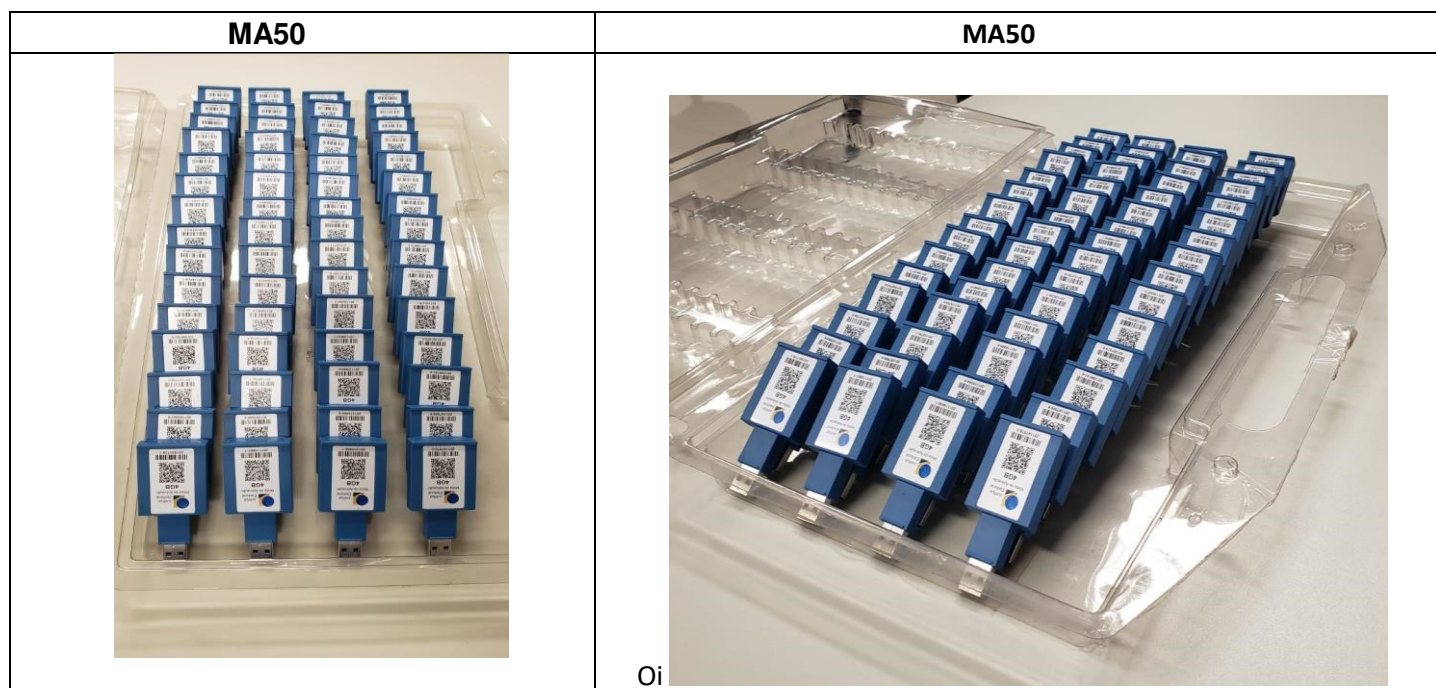

- 4) MA50 - Foto com um segundo tipo de sugestão de layout do estojo para armazenamento de, pelo menos, 50 mídias de resultado, no modelo MA50:

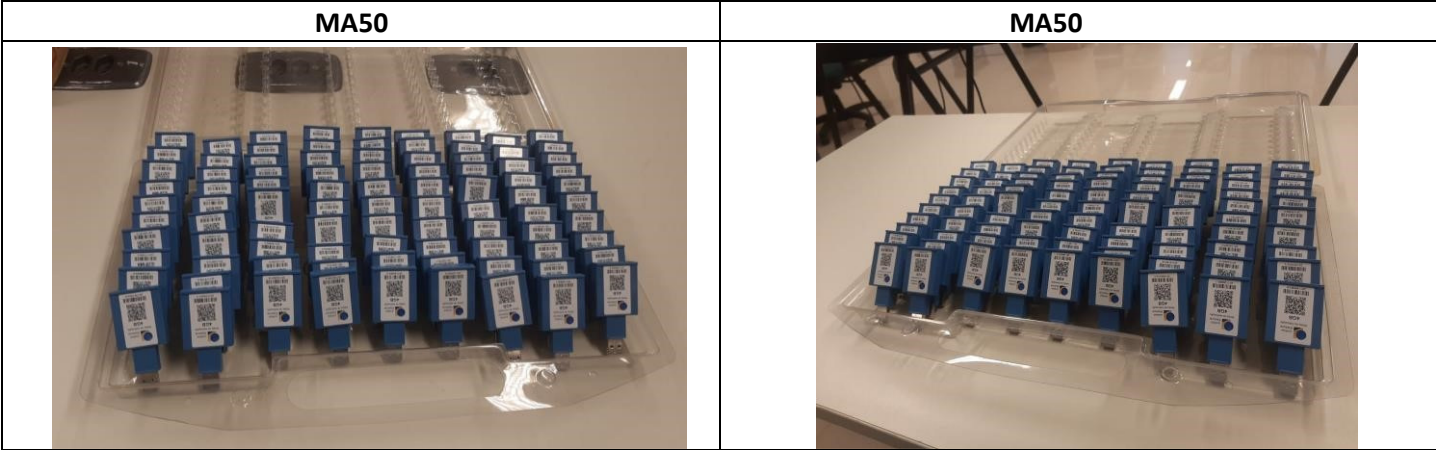

- 5) Tipos de bordas a serem desenvolvidas para atender a necessidade do TRE/MS: **Borda com Chanfro 0,5 cm.**

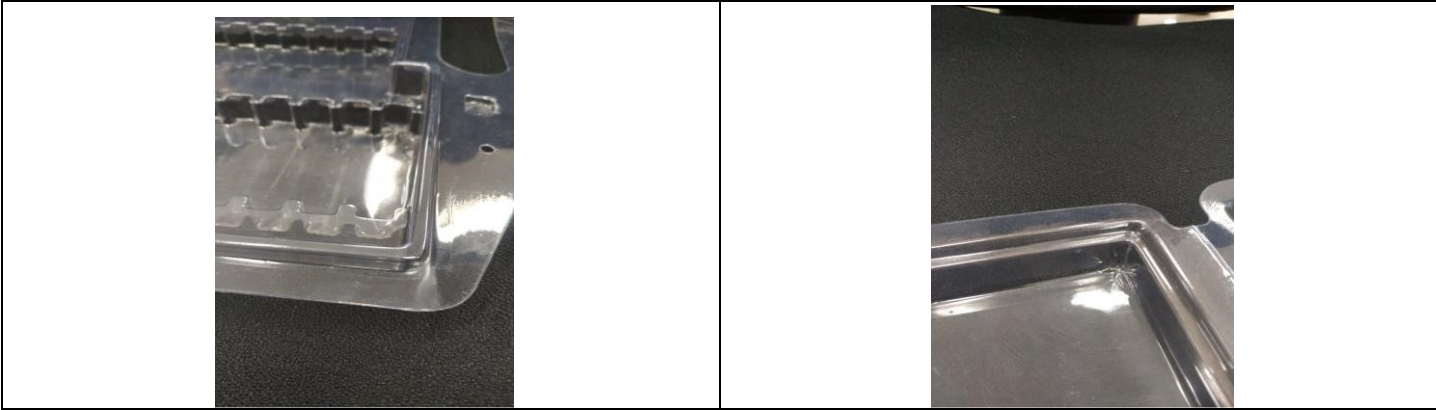

- 6) Tipos de bordas que o TRE/MS NÃO tem interesse: **Borda sem Chanfro.**



1	2	3	4
NO.	REV.	DESCRIPTION	DATE
1	10	UPDATED FOR UE2022 PROJECT	01/01/2022

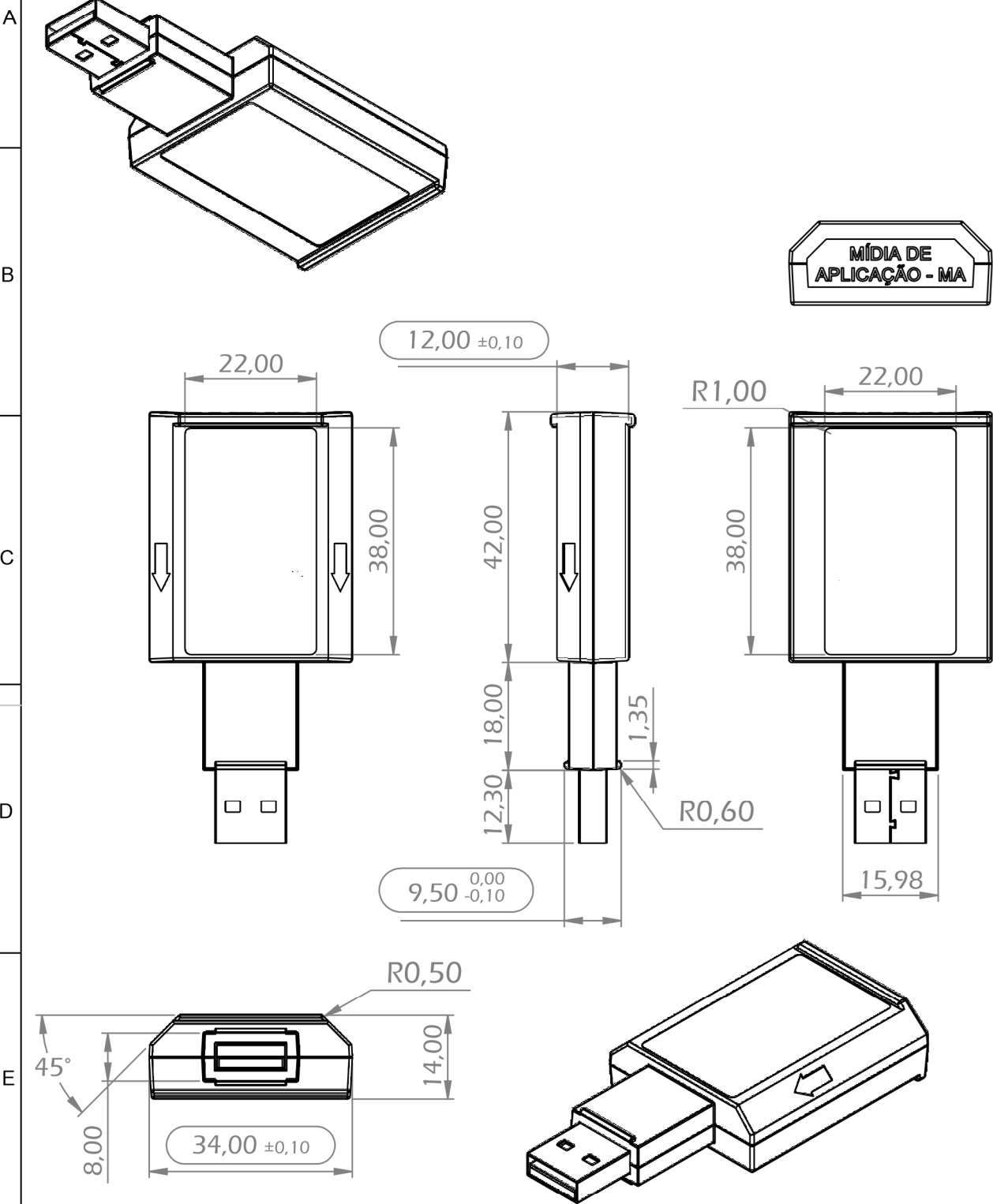

1

TITLE MÍDIA DE APLICAÇÃO		MATERIAL ABS PANTONE 7627C		PROJECT AND DRAW PROTON DESIGN MOBILE 11 999-333-322 SKYPE NETTO17	
COMPANY POSITIVO		SURFACE FINISH TEXTURED MT-11010		SCALE 1:1	THIRD ANGLE 3 DIEDRO
PROJECT UE2022/UE-2020		PROTON CODE PS-UE20-04		UNITS mm	
PART NUMBER		DO NOT SCALE DRAWING		TOLERANCE +/-0.1	
				DATE 27 MAI 19	LAST REV. 01 JAN 22
				FILE MA	REV. 10

WWW.PROTONDESIGN.COM.BR
NETTO@PROTONDESIGN.COM.BR

A4

NO.	REV.	DESCRIPTION	DATE
1	7	UPDATED FOR UE2022 PROJECT	01/01/2022

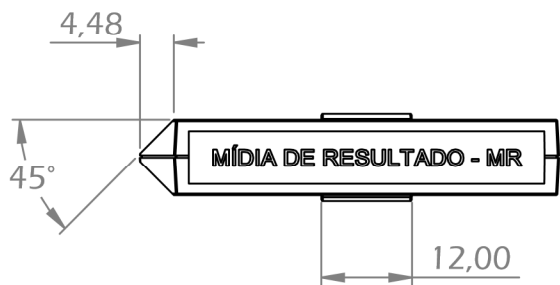
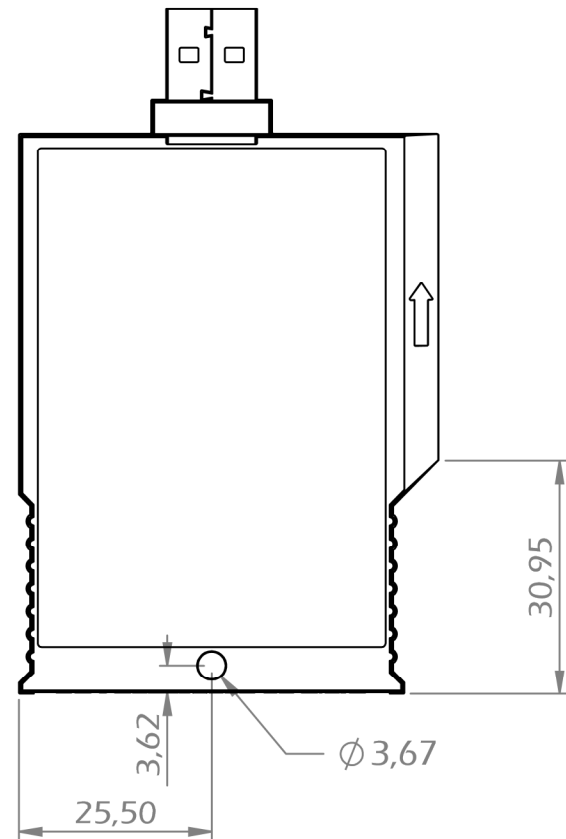
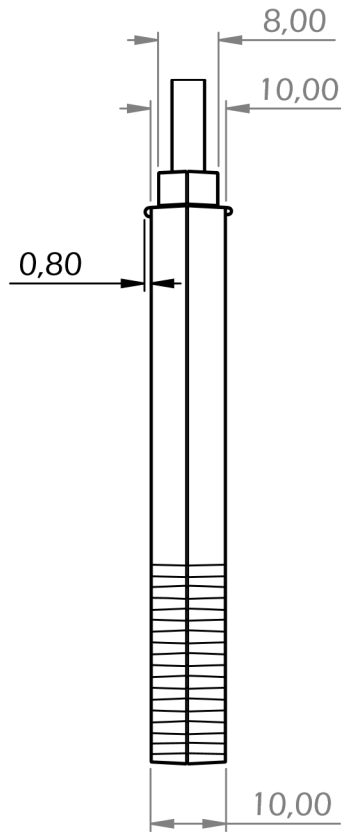
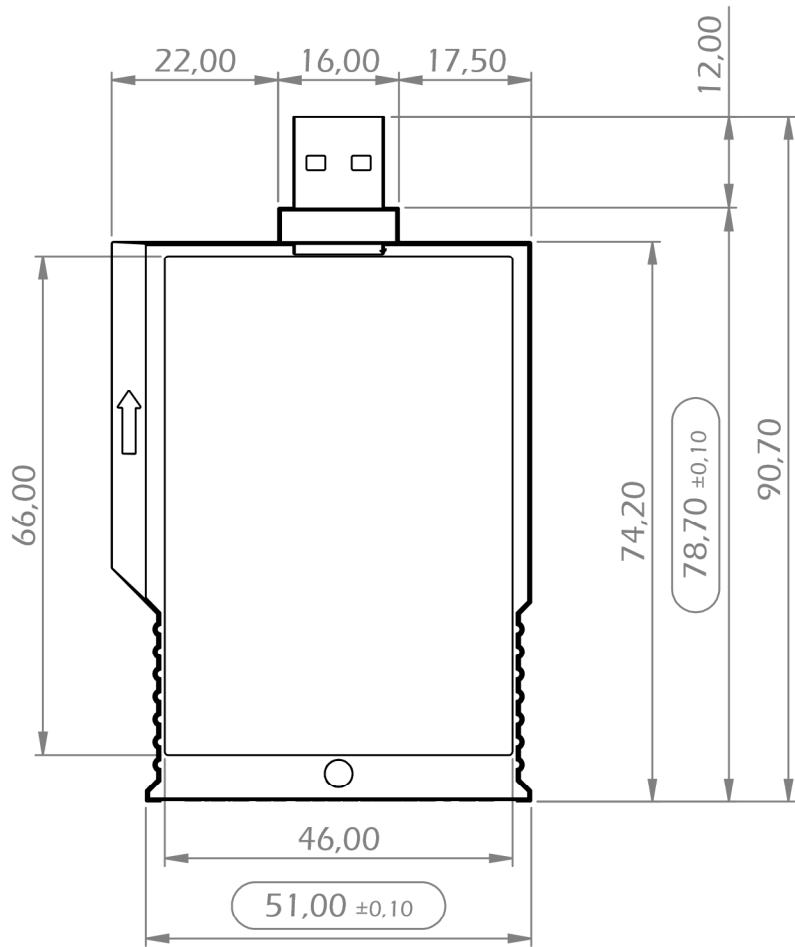
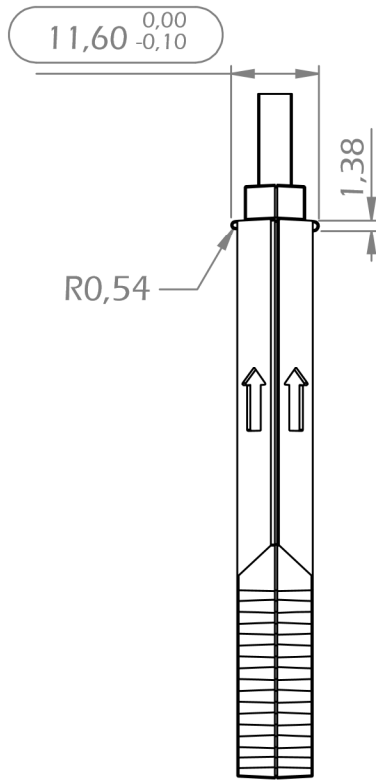
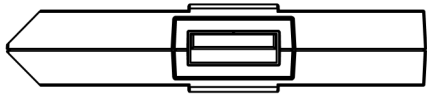
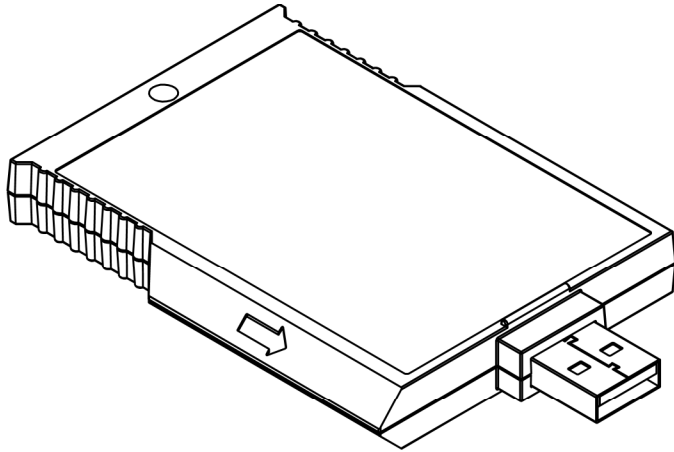
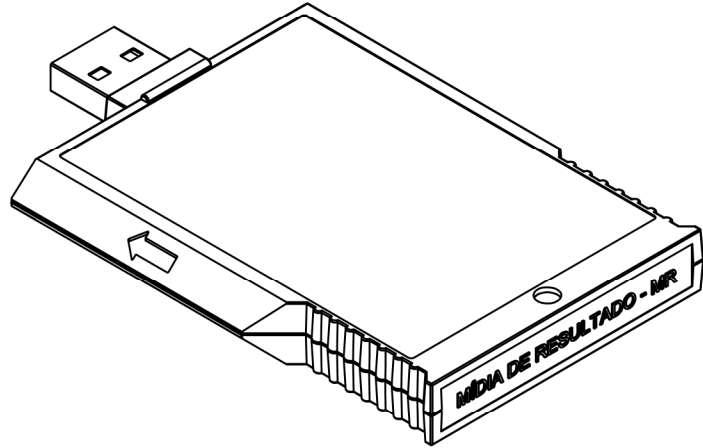

TITLE	MÍDIA DE RESULTADO
COMPANY	POSITIVO
PROJECT	UE2022/UE-2020
PART NUMBER	

MATERIAL	ABS PANTONE 7627C
SURFACE FINISH	TEXTURED MT-11010
PROTON CODE	PS-UE20-11
DO NOT SCALE DRAWING	

PROJECT AND DRAW	PROTON DESIGN	MOBILE 11 999-333-322	SKYPE NETTO17
SCALE	1:1	THIRD ANGLE	3 DIEDRO
UNITS	mm	TOLERANCE	+/-0.1
DATE	12 JUN 19	LAST REV.	01 JAN 22
FILE	MR	REV.	7